

Under the web-address <https://www.process-informatik.de> are product specific documentations or software-driver/-tools available to download.

If you have questions or suggestions about the product, please don't hesitate to contact us.

Process-Informatik Entwicklungsgesellschaft mbH

Im Gewerbegebiet 1

DE-73116 Wäschenbeuren

+49 (0) 7172-92666-0

[info@process-informatik.de](mailto:info@process-informatik.de)

<https://www.process-informatik.de>

**Menutree Website:**

- + Products / docu / downloads
- + Accessories
- + Connector / Power supply
- + Connector 2pins big



**QR-Code Website:**



Please make sure to update your drivers before using our products.

## Extend MPI/DP-bus over network or convert to network

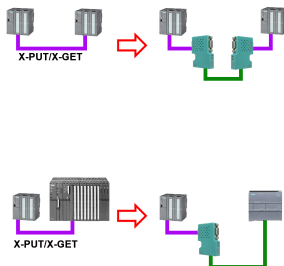

MPI/DP communication between two S7-300/400 controllers on the same bus

- a control is relocated spatially:

2x S7-LAN with activated X\_PUT/X\_GET module, the data is transported between the modules via the network.

- a control is replaced by a PN control:

1x S7-LAN with activated X\_PUT/X\_GET module and the received-data are transferred automatically to the configured PN-PLC via PUT/GET.

## Data backup S7-PLC PN-port on SD-card

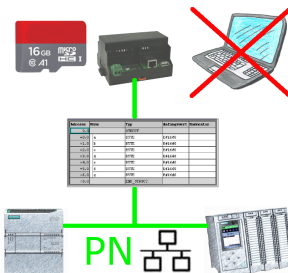

S7-PLC triggered DB-backup/-restore without additional PC via PN-port on SD card

## Sending ASCII-data to a PC



Your car park or control sends the configuration/capacity utilisation to a PC with a modem, so that the data can be used for further processing.

## Data backup S7-PLC over MPI/Profibus on FTP-server

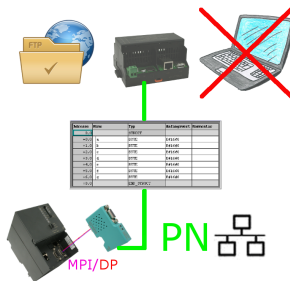

S7-PLC triggered DB-backup/-restore without additional PC via MPI/Profibus on FTP-server

## Message dispatch from the PLC

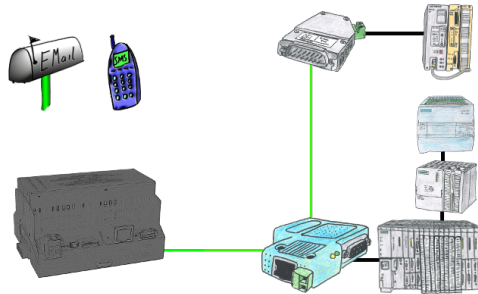

Send directly from your PLC news, statuses, alarms as SMS or email.

## Current S7 panels via WLAN to the S5 controller

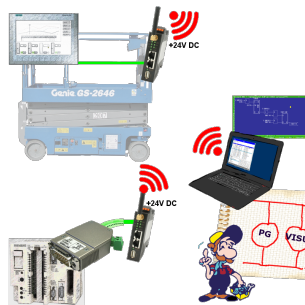

Connect each S7-TCP-IP panel to your S5.  
Now also available via WLAN for mobile workstations.  
PARALLEL several panels and even simultaneous PG connections possible.  
Include hard-to-reach places in your ERP system.