

Under the web-address <https://www.process-informatik.de> are product specific documentations or software-driver/-tools available to download.  
If you have questions or suggestions about the product, please don't hesitate to contact us.

Process-Informatik Entwicklungsgesellschaft mbH  
Im Gewerbegebiet 1  
DE-73116 Wäschenbeuren  
+49 (0) 7172-92666-0  
[info@process-informatik.de](mailto:info@process-informatik.de)  
<https://www.process-informatik.de>

**Menutree Website:**

- + Products / docu / downloads
- + Accessories
  - + Connection cable / adapter
  - + RS232
  - + Serial cable 9-pin



**QR-Code Website:**



Please make sure to update your drivers before using our products.

## Data backup S7-PLC over MPI/Profibus on FTP-server

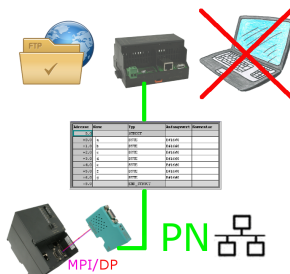

S7-PLC triggered DB-backup/-restore without additional PC via MPI/Profibus on FTP-server

## Saving of phone cost through call-back

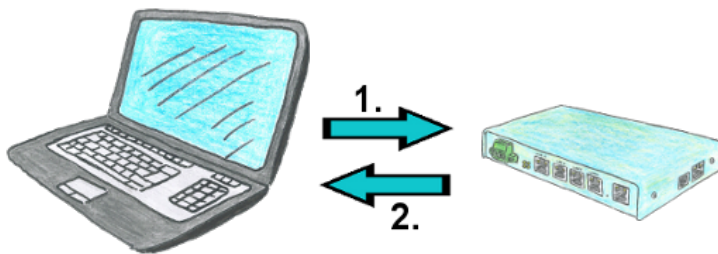

You need a communication over the phone with your operation of facilities, but do not want to pay the phone bills? No problem, with the TELE-router you are able to work even with recall. This means that you first call the device and tell him that you want a call back. If the credentials are correct and the recall is permitted, the TELE-router connection is terminated and then it calls back the transferred number. Your customer shall bear the cost of the connection.

## Display diagnostic-buffer without Simatic-Manager

Diagnose für Subsystem 42 (diagnose)	
<b>Diagnose-Identifikation</b> Subsystem: 42 (diagnose) Subsystem-Adresse: 100 (diagnose)	
<b>Diagnose-Zustand</b> Diagnose-Zustand: OK Diagnose-Modus: 0000000000000000 Diagnose-Modus: 0000000000000000 Diagnose-Modus: 0000000000000000 Diagnose-Modus: 0000000000000000	
<b>Diagnose-Register</b>	
Register-Adresse	Register-Wert
00000000	0000000000000000
00000001	0000000000000000
00000002	0000000000000000
00000003	0000000000000000
00000004	0000000000000000
00000005	0000000000000000
00000006	0000000000000000
00000007	0000000000000000
00000008	0000000000000000
00000009	0000000000000000
0000000A	0000000000000000
0000000B	0000000000000000
0000000C	0000000000000000
0000000D	0000000000000000
0000000E	0000000000000000
0000000F	0000000000000000
00000010	0000000000000000
00000011	0000000000000000
00000012	0000000000000000
00000013	0000000000000000
00000014	0000000000000000
00000015	0000000000000000
00000016	0000000000000000
00000017	0000000000000000
00000018	0000000000000000
00000019	0000000000000000
0000001A	0000000000000000
0000001B	0000000000000000
0000001C	0000000000000000
0000001D	0000000000000000
0000001E	0000000000000000
0000001F	0000000000000000
00000020	0000000000000000
00000021	0000000000000000
00000022	0000000000000000
00000023	0000000000000000
00000024	0000000000000000
00000025	0000000000000000
00000026	0000000000000000
00000027	0000000000000000
00000028	0000000000000000
00000029	0000000000000000
0000002A	0000000000000000
0000002B	0000000000000000
0000002C	0000000000000000
0000002D	0000000000000000
0000002E	0000000000000000
0000002F	0000000000000000
00000030	0000000000000000
00000031	0000000000000000
00000032	0000000000000000
00000033	0000000000000000
00000034	0000000000000000
00000035	0000000000000000
00000036	0000000000000000
00000037	0000000000000000
00000038	0000000000000000
00000039	0000000000000000
0000003A	0000000000000000
0000003B	0000000000000000
0000003C	0000000000000000
0000003D	0000000000000000
0000003E	0000000000000000
0000003F	0000000000000000
00000040	0000000000000000
00000041	0000000000000000
00000042	0000000000000000
00000043	0000000000000000
00000044	0000000000000000
00000045	0000000000000000
00000046	0000000000000000
00000047	0000000000000000
00000048	0000000000000000
00000049	0000000000000000
0000004A	0000000000000000
0000004B	0000000000000000
0000004C	0000000000000000
0000004D	0000000000000000
0000004E	0000000000000000
0000004F	0000000000000000
00000050	0000000000000000
00000051	0000000000000000
00000052	0000000000000000
00000053	0000000000000000
00000054	0000000000000000
00000055	0000000000000000
00000056	0000000000000000
00000057	0000000000000000
00000058	0000000000000000
00000059	0000000000000000
0000005A	0000000000000000
0000005B	0000000000000000
0000005C	0000000000000000
0000005D	0000000000000000
0000005E	0000000000000000
0000005F	0000000000000000
00000060	0000000000000000
00000061	0000000000000000
00000062	0000000000000000
00000063	0000000000000000
00000064	0000000000000000
00000065	0000000000000000
00000066	0000000000000000
00000067	0000000000000000
00000068	0000000000000000
00000069	0000000000000000
0000006A	0000000000000000
0000006B	0000000000000000
0000006C	0000000000000000
0000006D	0000000000000000
0000006E	0000000000000000
0000006F	0000000000000000
00000070	0000000000000000
00000071	0000000000000000
00000072	0000000000000000
00000073	0000000000000000
00000074	0000000000000000
00000075	0000000000000000
00000076	0000000000000000
00000077	0000000000000000
00000078	0000000000000000
00000079	0000000000000000
0000007A	0000000000000000
0000007B	0000000000000000
0000007C	0000000000000000
0000007D	0000000000000000
0000007E	0000000000000000
0000007F	0000000000000000
00000080	0000000000000000
00000081	0000000000000000
00000082	0000000000000000
00000083	0000000000000000
00000084	0000000000000000
00000085	0000000000000000
00000086	0000000000000000
00000087	0000000000000000
00000088	0000000000000000
00000089	0000000000000000
0000008A	0000000000000000
0000008B	0000000000000000
0000008C	0000000000000000
0000008D	0000000000000000
0000008E	0000000000000000
0000008F	0000000000000000
00000090	0000000000000000
00000091	0000000000000000
00000092	0000000000000000
00000093	0000000000000000
00000094	0000000000000000
00000095	0000000000000000
00000096	0000000000000000
00000097	0000000000000000
00000098	0000000000000000
00000099	0000000000000000
0000009A	0000000000000000
0000009B	0000000000000000
0000009C	0000000000000000
0000009D	0000000000000000
0000009E	0000000000000000
0000009F	0000000000000000
000000A0	0000000000000000
000000A1	0000000000000000
000000A2	0000000000000000
000000A3	0000000000000000
000000A4	0000000000000000
000000A5	0000000000000000
000000A6	0000000000000000
000000A7	0000000000000000
000000A8	0000000000000000
000000A9	0000000000000000
000000AA	0000000000000000
000000AB	0000000000000000
000000AC	0000000000000000
000000AD	0000000000000000
000000AE	0000000000000000
000000AF	0000000000000000
000000B0	0000000000000000
000000B1	0000000000000000
000000B2	0000000000000000
000000B3	0000000000000000
000000B4	0000000000000000
000000B5	0000000000000000
000000B6	0000000000000000
000000B7	0000000000000000
000000B8	0000000000000000
000000B9	0000000000000000
000000BA	0000000000000000
000000BB	0000000000000000
000000BC	0000000000000000
000000BD	0000000000000000
000000BE	0000000000000000
000000BF	0000000000000000
000000C0	0000000000000000
000000C1	0000000000000000
000000C2	0000000000000000
000000C3	0000000000000000
000000C4	0000000000000000
000000C5	0000000000000000
000000C6	0000000000000000
000000C7	0000000000000000
000000C8	0000000000000000
000000C9	0000000000000000
000000CA	0000000000000000
000000CB	0000000000000000
000000CC	0000000000000000
000000CD	0000000000000000
000000CE	0000000000000000
000000CF	0000000000000000
000000D0	0000000000000000
000000D1	0000000000000000
000000D2	0000000000000000
000000D3	0000000000000000
000000D4	0000000000000000
000000D5	0000000000000000
000000D6	0000000000000000
000000D7	0000000000000000
000000D8	0000000000000000
000000D9	0000000000000000
000000DA	0000000000000000
000000DB	0000000000000000
000000DC	0000000000000000
000000DD	0000000000000000
000000DE	0000000000000000
000000DF	0000000000000000
000000E0	0000000000000000
000000E1	0000000000000000
000000E2	0000000000000000
000000E3	0000000000000000
000000E4	0000000000000000
000000E5	0000000000000000
000000E6	0000000000000000
000000E7	0000000000000000
000000E8	0000000000000000
000000E9	0000000000000000
000000EA	0000000000000000
000000EB	0000000000000000
000000EC	0000000000000000
000000ED	0000000000000000
000000EE	0000000000000000
000000EF	0000000000000000
000000F0	0000000000000000
000000F1	0000000000000000
000000F2	0000000000000000
000000F3	0000000000000000
000000F4	0000000000000000
000000F5	0000000000000000
000000F6	0000000000000000
000000F7	0000000000000000
000000F8	0000000000000000
000000F9	0000000000000000
000000FA	0000000000000000
000000FB	0000000000000000
000000FC	0000000000000000
000000FD	0000000000000000
000000FE	0000000000000000
000000FF	0000000000000000

Via the connection-menu and the included bus-device-display, it is possible to display the diagnostics buffer of the respective device without having to open Simatic-Manager or TIA-Portal separately.

The data received from the module is output directly in one piece without the hassle of changing tabs. All data at a glance.

## WinTELEPROF-software = software-PG-TELE

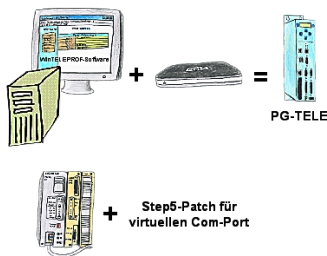

You're using the devices of the Tele-Network-family and don't want to have a device standing on the table? No problem. Install the WinTELEPROF-software on your PC and after link connection access to your Step5/7-programming software (also Siemens) via a virtual Com-Port.

At Step5 the Step5-software is going to be patched, then working with the virtual Com-Port will be also possible.

## Data backup S5-PLC on USB-stick

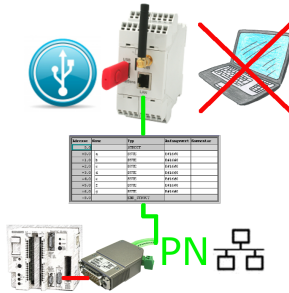

S5-PLC triggered DB-backup/-restore without additional PC via PG-socket and Ethernet on USB-stick

## Detect Profinet burglary



Detection and logging of unauthorized access in the defined Profinet

Attempted break-ins and access to the network are recognized immediately and e.g. reported by email

Logging of all accesses in the network for historical processing

Possible data-storage USB-stick or FTP-server via USB-network-stick.