

Under the web-address <https://www.process-informatik.de> are product specific documentations or software-driver/-tools available to download.  
If you have questions or suggestions about the product, please don't hesitate to contact us.

Process-Informatik Entwicklungsgesellschaft mbH  
Im Gewerbegebiet 1  
DE-73116 Wäschenbeuren  
+49 (0) 7172-92666-0  
[info@process-informatik.de](mailto:info@process-informatik.de)  
<https://www.process-informatik.de>

**Menutree Website:**

- + Products / docu / downloads
- + Hardware
- + Time
- + DCF-amplifier



**QR-Code Website:**



Please make sure to update your drivers before using our products.

## Easy Web-Visualization



You need a web-visualization which is kept simple, with no additional Plugins like ActiveX, Flash(R) or Java(R) and is compatible with most general browser? Then you have found with S7-Visu the solution. Visualizations under Windows(R)/Linux on PC-based systems are just realizable as those for tablets or Phones with browser support. The simultaneous operation of multiple browsers at the same time is possible.

## Transformation of Rack/Slot in TSAP to MPI-address

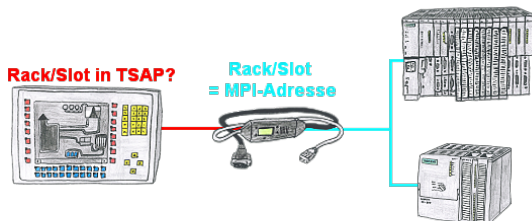

Your panel or visualisationsystem addresses the used PLC with Rack/Slot in TSAP? No problem, activate this mode in the MPI-LAN-cable and you will get actual data from the PLC.

## Data backup S5-PLC on SD-card

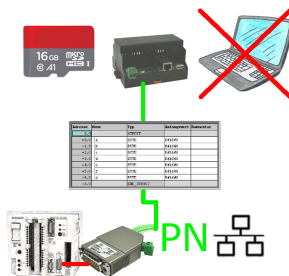

S5-PLC triggered DB-backup/-restore without additional PC via PG-socket and Ethernet on SD-card

## Independent operation through power-pack-supply

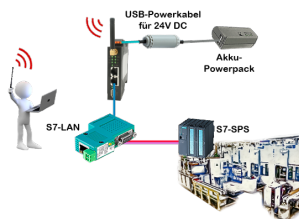

You want for e.g. moving around your system/control and need a 24V-DC-supply for your access-point ALF-UA?

With USB-power-cable and a USB-power-bank/-accu, the problem can be solved immediately with little effort.

## Detect failure of Profinet-devices



Identify devices that are likely to fail in the near future.  
Detect defective devices that no longer respond to PN protocols.  
Defective devices are reported by email and logged.  
No long troubleshooting thanks to exact station information.

## Battery buffered time

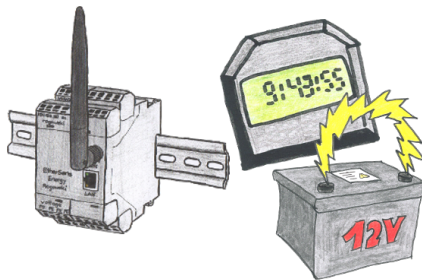

You always need a current time, but do not always have a time-server on site. With the integrated battery-backed RTC you always have the current time in the unit. Even if the power fails, the time in the unit continues to operate, so that when the voltage returns, the time continues to run correctly.